

Recommended
P.C. Board SMD Layout

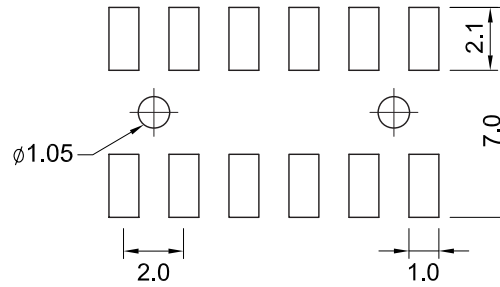

Specifications

Current Rating: 2 Amps
 Insulator Resistance: 1000 Megohms min.
 Contact Resistance: 20 m ohms max.
 Dielectric Withstanding: AC 500V
 Operating Temperature : -40°C ~ +125°C
 Contact Material: Phosphor Bronze
 Insulator Material: Polyester, UL 94V-0, Nylon-9T
 Contact Plated: See Option / Standard = Full Gold Flash

Part Numbering System

FH2C-SD-434060 - XX - X X X X N

Series _____
No. of Pins _____
Post Option: _____
 Nil = w/o Alignment Pin
 A = with Alignment Pin
Contact Plating: _____
Cap Option: _____
 Nil = No Cap
 F = Film
 M = Metal
 P = Plastic
Packing Method: _____
 B = Tube
 T = Tape & Reel
Insulator Material: _____
 N = High Temperature Nylon-6T

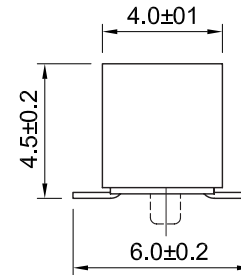
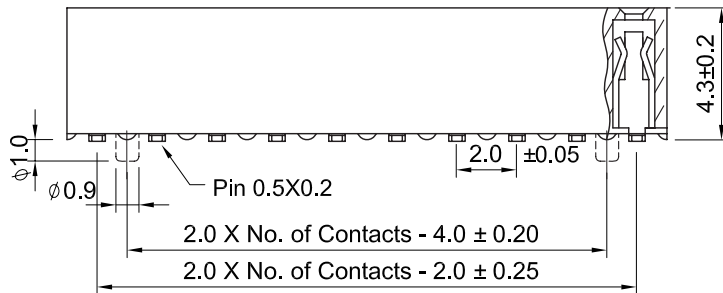

* Contact
Plating
Option

Full Gold Plating

Gold Plated On Contact Area
Tin Plated on Solder Area

Full Tin Plating

G : Gold Flash
G10: Gold 10u"
G15: Gold 15u"
G30: Gold 30u"

S: Gold Flash
S10: Gold 10u"
S15: Gold 15u"
S30: Gold 30u"

T: Tin 100u"

General Tolerance

X. ± 0.50 X.° ± 5°

.X ± 0.20 .X° ± 2°

.XX ± 0.10 .XX° ± 1°

Units : mm